

**INSTRUCTIONS FOR INSTALLING THE R K P CLOSING WHEEL ARM PIVOT KIT ON JOHN DEERE NO-TILL DRILLS WITH SLEEVE BEARINGS AND BOLTED PIVOT BUSHINGS MODEL 750 (SERIAL # 6000 AND UP), 1850 AND 1560, 1860 (SHOWN)**

Before working on your drill review the safety section in your operators manual.

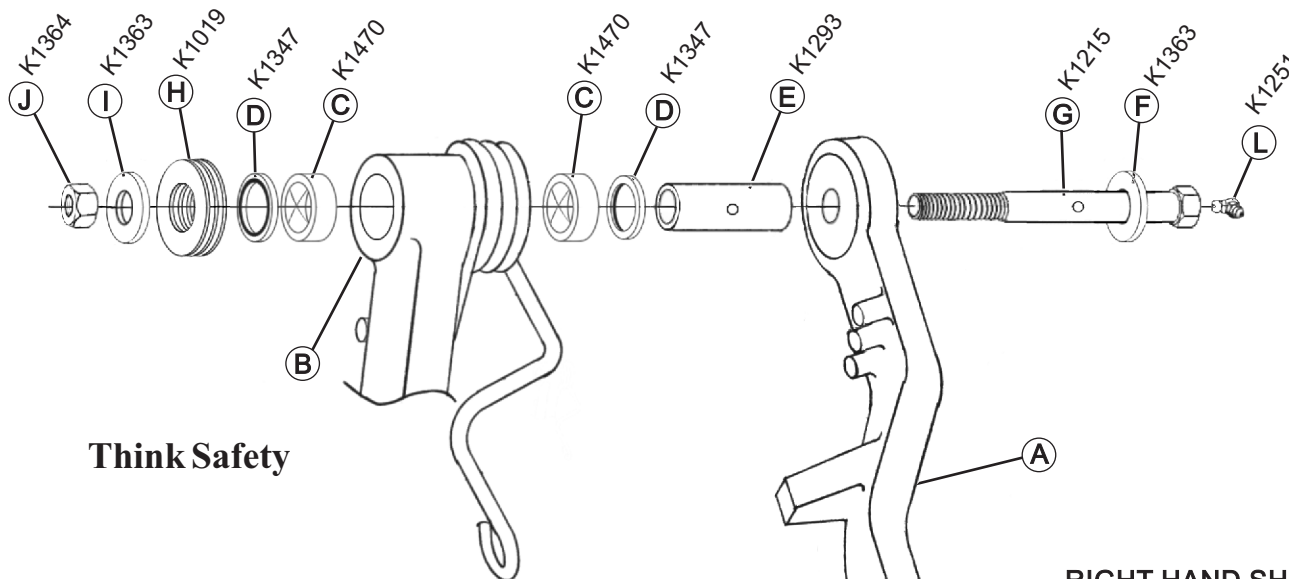

**Think Safety**

**RIGHT HAND SHOWN**

**REMOVAL**

1. Remove arm (A). Remove old sleeve bearings. Remove dirt from bore of bearing housing (B).

**INSTALL SLEEVE BEARINGS AND SEALS**

2. Install new grooved sleeve bearings (C). Outer end of bearings should be 1/4" from end of bearing housing. Note that a pilot bushing is available from RKP to facilitate installation of the sleeve bearings and seals.
3. If a grease zerk which was previously installed in bearing housing is to be used it may be necessary to drill a small hole (approximately 1/8") through the sleeve bearing in line with the tapped hole in the bearing housing.
4. Run reamer through sleeve bearings. Check by inserting pivot bushing (E). Remove pivot bushing. See special instructions for use of reamer.
5. Install seals (D) with lip outward. Press seals into bearing housing until flush.
6. Apply grease to lips of seals (D) and to one end of pivot bushing (E). Install pivot bushing into bearing housing being careful not to damage seals.

**ASSEMBLY**

7. Install washer (F) onto bolt (G). Install bolt through arm and pivot bushing.
8. Install adjusting washer(s) (H) as required to minimize axial movement. Install washer (I) and a regular 5/8" nut then tighten.
9. Install grease zerk (L). Note that the zerk can be directed to improve accessibility. Loosen nut and rotate bolt if necessary to redirect the zerk.
10. When you are satisfied with the installation replace regular nut with locknut (J) and tighten to 140 ft lbs.
11. Grease the pivot. A 50 hour interval thereafter is recommended.